



BRINGING
Families
TOGETHER





MARCO



WE HAVE AS MUCH FUN MAKING YOUR POOL AS YOU'LL HAVE SWIMMING IN IT.

NOTICE AND DISCLAIMER	2
SAFETY INFORMATION	3
MANUFACTURING	4-5
INNOVATIONS	6-7
POOL DESIGN OVERVIEW	8-9
C SERIES	10-13
I SERIES	14-17
D SERIES	18-21
PHOTO GALLERY	22-25
R SERIES	26-29
L SERIES	30-33
T SERIES	34-37
M SERIES	38-41
X SERIES	42-45
SPAS	46
TANNING LEDGES	47
POOL COLORS	48-49
OUR COMMITMENTS	50-53
WATER CHEMISTRY / POOL COVER	54
WHAT TO EXPECT	55
WARRANTY	56



NOTICE AND DISCLAIMER

This NOTICE AND DISCLAIMER is made to all retail customers purchasing any River Pools® or Thursday Pools® pool shell or otherwise dealing with a River Pools or Thursday Pools dealer or franchisee.

Thursday Pools, LLC manufactures River Pools® and Thursday Pools® pool shells and sells those pool shells to locally owned and independently operated dealers. Those dealers resell and install those pool shells for their customers. Thursday Pools, LLC also manufactures River Pools pool shells and sells them to independently owned and operated franchisees who have franchise agreements with River Pools Franchising, LLC. River Pools Franchising, LLC provides those franchisees with the non-exclusive right to market the River Pools pool shells as a franchisee. River Pools Franchising, LLC does not manufacture pool shells, and neither Thursday Pools, LLC nor River Pools Franchising, LLC install pool shells or guarantee the obligations of any dealers or franchisees. No dealer or franchisee is an owner, agent, or employee of Thursday Pools, LLC, and no dealer or franchisee is an agent of River Pools Franchising, LLC or has authority to act on behalf of Thursday Pools, LLC or River Pools Franchising, LLC. Thursday Pools, LLC and River Pools Franchising, LLC each disclaim any responsibility or liability for the actions or inactions of any dealer or franchisee. Any statement in any advertisement, literature, brochure or website, or statement by any dealer, franchisee or other individual should not be interpreted or construed to expressly or impliedly create any relationships contrary to this Notice and Disclaimer.

POOL SAFETY

Pool owners should always think of SAFETY FIRST. They should take specific steps to ensure that their family members and guests are knowledgeable about the safe and sensible use of their pool. It's also a good idea for pool owners to contact their local American Red Cross for available CPR classes and other vital safety programs. Pool owners should ensure:

1. That their pool is never used unless there is adequate supervision.
2. That their pool is kept in good repair and is not used when there is a missing or broken drain cover or other component.
3. That ALL CHILDREN using their pool are under constant supervision.
4. That anyone under the influence of alcohol, drugs, or stimulants that would impair their abilities or judgment does not use the pool.
5. That their pool is protected by appropriate barriers to prevent unsupervised entry, including, but not limited to, fencing with self-latching gates, automatic pool covers, alarms, etc., as required by local laws and safety standards.
6. That their pool builder has supplied them with all of the safety information that accompanies the pool and that they have installed the provided warning stickers and signs where they can be clearly visible to all who use the pool.
7. That for increased child safety, they always remove all toys from in and around the pool and store them out of sight when the pool is not in use.
8. That no pool users dive or jump in the pool.
9. That additional important safety information accompanying their pool is reviewed carefully before use.

Please note: Items that are essential for the safe use of your pool may not be visible in many of the photographs contained in this brochure, either because of perspective or camera angle, or because they were removed for photographic purposes. These items include, but are not limited to:

1. Safety ropes, which should remain in place at all times.
2. "No Diving" signs, which are provided and should be installed where they are clearly visible in accordance with instructions included in the Owner's Manual.
3. Necessary means of exit and entry into the pool.
4. Approved drain covers and other devices to protect against suction entrapment.
5. Minimum required inlets and returns to ensure proper water circulation.
6. Appropriate in-pool lighting if the pool will be used after dark.

All of these devices should be installed in accordance with manufacturers' instructions, the National Pool and Hot Tub Alliance standards, as well as state and local statutes and codes.

If the pool is labeled by River Pools as NON-DIVING, then diving equipment may not be installed, and any such equipment must be removed before the pool is used.

River Pools strongly recommends that diving boards and slides not be installed or used with its pools, given the inherent dangers associated with diving boards and slides in residential pools. These dangers include brain, spinal cord and other severe permanent injuries, and death. For that reason, River Pools does not manufacture or sell diving boards or slides. If, despite this warning and recommendation, the owner decides to install or use a diving board or slide, the owner assumes all risks inherent with a diving board or slide, and River Pools further warns that diving boards and slides require minimum depths and distances and must be installed and used in strict compliance with the equipment manufacturer's specifications and ANSI/NSPI, ANSI/APSP, and ANSI/APSP/ICC standards, as well as in compliance with all applicable laws, rules and regulations. The owner is responsible for making sure the pool is appropriate for diving boards and slides and otherwise meets all standards and laws for diving pools, and the owner must consult the diving board or slide manufacturer and/or installer as to the appropriateness of the pool for the diving board or slide and that its installation, location and use meet all standards and laws for diving and slide pools.

MANUFACTURING

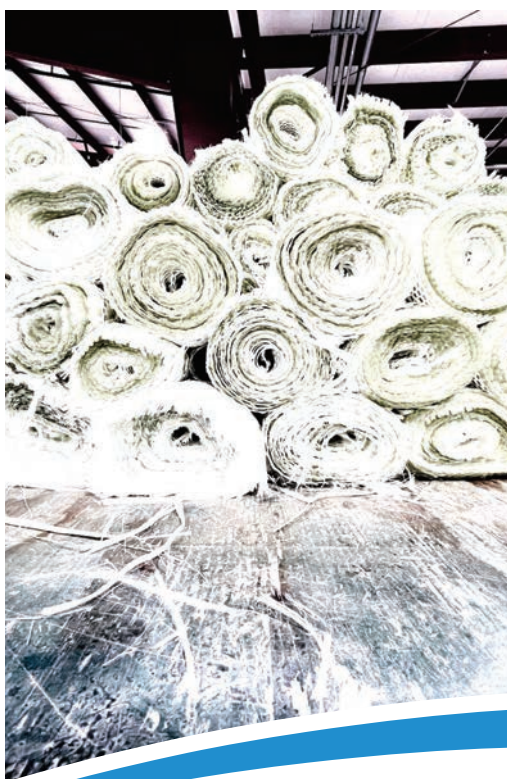
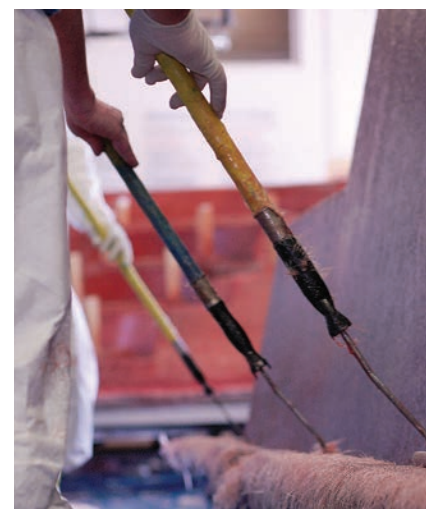
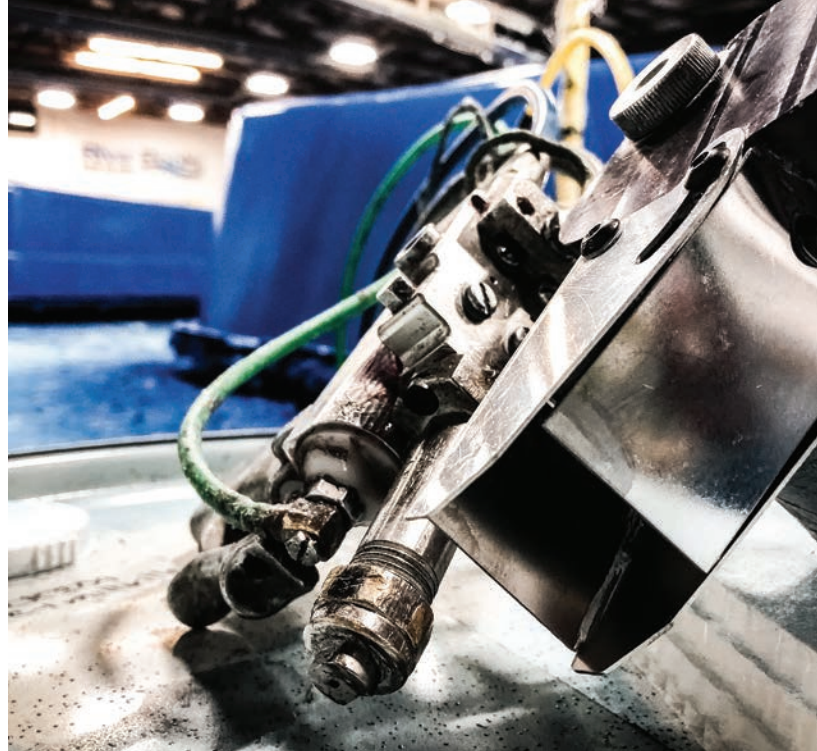

ADVANCED FIBERGLASS POOLS MANUFACTURING



A POOL ISN'T JUST A POOL.

It's a place to strengthen bonds, have fun, and make countless memories. We craft our pools to last so that your family will have the opportunity to enjoy it and spend summer after summer together in a place that's all your own.

Creating a high-quality fiberglass pool that's built to last starts with the mold from which your pool is built. The manufacturing campus is intentionally designed to eliminate factors that compromise a mold's integrity. Our state-of-the-art plant ensures that molds are stored indoors and moved around on flat surfaces. Our workflow minimizes unnecessary movement of the molds.

Because our pools are crafted, cured, trimmed and prepped indoors, you end up with a swimming pool that's not only beautiful and solid on the outside, but also on the inside.

Now, let's take a look at the quality materials that go into our pools.

GELCOAT

Our pool surface gelcoat is designed to last and look luxurious. It's smooth, resistant to algae, and a dog's claws won't scratch it. River Pools uses a high quality gelcoat, so you can feel confident in your purchase knowing that your pool surface is one of the most tested and reputable on the market.

CHOPPED AND HAND-LAID ROVING FIBERGLASS

Fiberglass is combined with 100 percent polyester resin in multiple pool layers. We use both equipment-applied chopped fiberglass and hand-laid applied fiberglass to get the optimal physical properties that a best-in-class fiberglass pool requires.

VINYL ESTER RESIN BARRIER

Our vinyl ester resin barrier coat prevents potential blistering and protects the surface finish of your pool.

HONEYCOMB CORE

We add vertical and horizontal supports throughout the pool using a honeycomb core structure. This construction technique is applied to all horizontal surfaces above the floor, such as steps, benches, and tanning ledges, and vertically along the pool wall.





THE Z LEDGE™

Pools with tanning ledges are more popular than ever. A tanning ledge provides a designated zone for chilling, kiddo-watching and, of course, tanning. And with fiberglass, the tanning ledge is already built into the design and ready to go when it reaches your home.

To enhance homeowner experience and improve the installation process, we created the Z Ledge. For the homeowner, the Z Ledge helps to ensure the ledge is level and solid underfoot. For installers, the Z Ledge helps them set a tanning ledge pool via a one-step process, eliminating the hassle of pouring concrete and providing a faster, higher-quality installation.

You can feel reassured that your investment is a solid one once you step onto a tanning ledge with firm backing from the Z Ledge.

THE DOUBLE-07® SKIMMER

Fiberglass pools (like practically any pool) have necessary accessories, such as the skimmer. A pool skimmer is designed to collect debris from the water's surface before it reaches the filter. While it may just seem like a necessary piece of equipment that comes with having a pool, there are actually limitations that can arise from skimmers.

- 1. The skimmer's placement can determine the water level in your pool. If installed too low, you may not be able to reach maximum water depth.**
- 2. It can be visually unappealing, especially in pools or backyards with more natural or rounded features. Plus, the typical square design often doesn't match features like LED lights, bubblers, etc.**
- 3. Skimmers can be more difficult to install as many do not account for the draft angle associated with most fiberglass pools.**

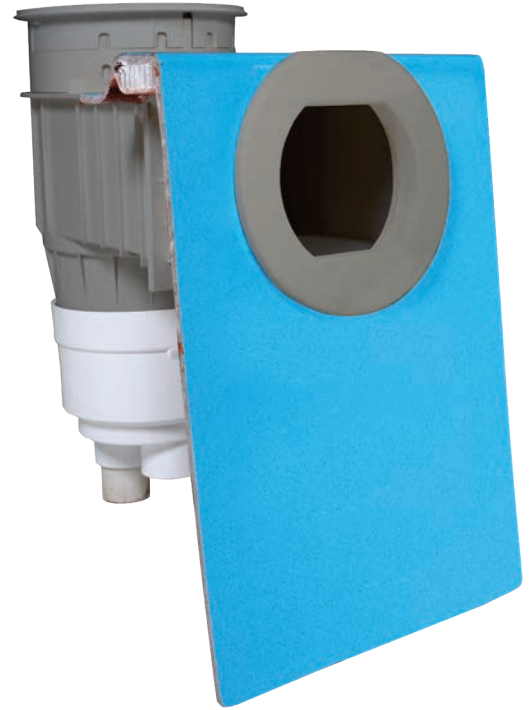

So how do you accommodate aesthetic and install concerns without detracting from the function of the skimmer? The answer is the Double-07.

Like the Z Ledge, the Double-07 Skimmer was crafted with both installers and homeowners in mind. The rounded faceplate creates a sleeker look that often matches the aesthetics of other pool features.

Installers will now have a much easier time properly installing the Double-07 with its 7-degree angle, fiberglass-pool-friendly design. Installers only need a 6-7/8" circular hole saw to get the Double-07 put in place. This means it will be easier for your builder to have the skimmer at the proper placement and ensure optimal water levels.

Because the top of the Double-07 Skimmer is not as angled as traditional skimmers, water won't drain out the back of the skimmer in the event that the pool water level gets too high.



POOL DESIGNS

MARCO

C SERIES

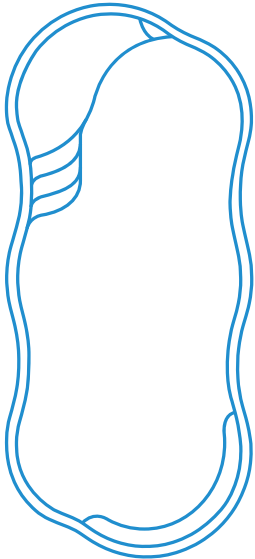

C40



C35



More info on pages 10-13

I SERIES

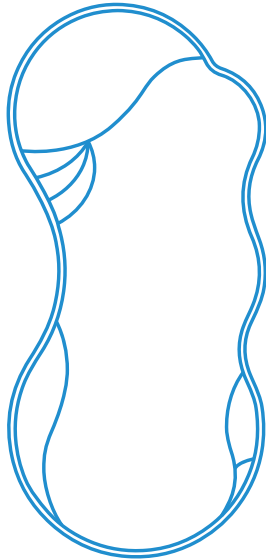

I34



I30s



I30



I25s



I25



More info on pages 14-17

D SERIES

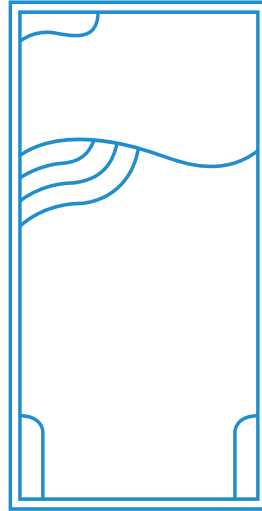

D40



D36



D32



D28



D24



More info on pages 18-21

R SERIES

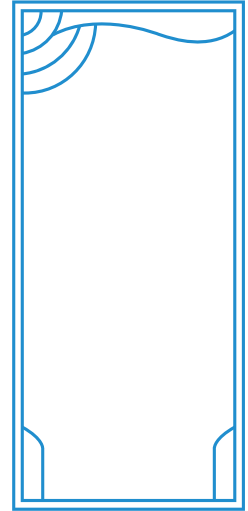

R40



R36



R32



R28



R24



R20



More info on pages 26-29

L SERIES

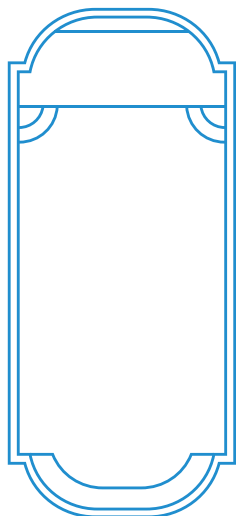

L36



More info on pages 30-33

T SERIES

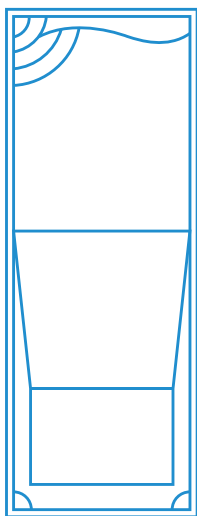

T40



More info on pages 34-37

M SERIES

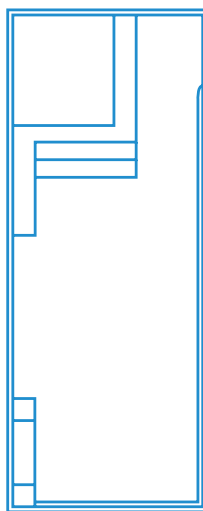

M35



M30



M25



More info on pages 38-41

X SERIES

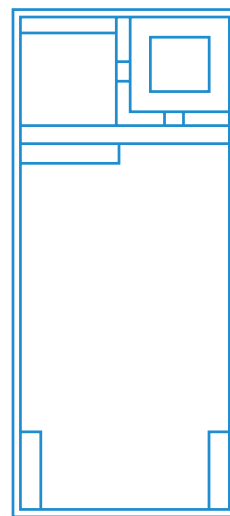

X36



More info on pages 42-45

C SERIES



The C Series packs tons of fun features into a single elegant design with its perfect blend of curb appeal and swim space.

MARCO



POLO

POLO

River Pools®
CATCH THE WAVE

C SERIES

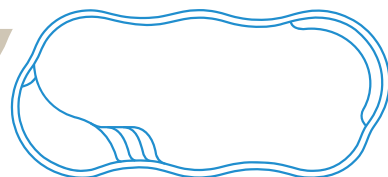

LOOKING FOR A TANNING LEDGE POOL WITH THE PERFECT BLEND OF CURB APPEAL AND SWIM SPACE? AS ONE OF THE MOST POPULAR FREEFORM POOLS AVAILABLE, THE C SERIES PACKS TONS OF FUN FEATURES INTO A SINGLE ELEGANT DESIGN.

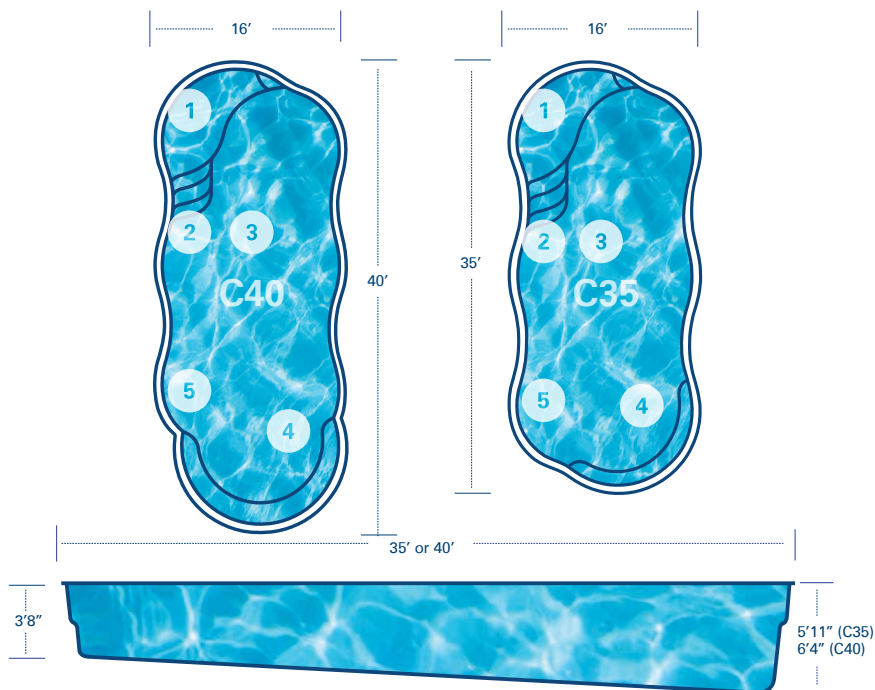

THE C SERIES FEATURES:

1 SPACIOUS TANNING LEDGE

Designed to accommodate multiple lounge chairs, the tanning ledge on the C Series provides plenty of room to kick back and immerse yourself in a good book and catch some rays. Ask your installer about adding bubblers to up the fun factor.

2 EASY-ENTRY POOL STEPS

The cascading steps of the C Series are specially designed for easy entry and exit of the pool.

3 OPEN POOL INTERIOR

Swim and play away. The C Series is a spacious free-form fiberglass pool design with an open interior.

4 GENEROUS DEEP-END BENCH

Relax in style with this generous seating area and enjoy a great space for the entire family to relax together. Ask your installer about adding spa jets for the ultimate therapeutic experience.

5 TEXTURED POOL STEPS, TANNING LEDGE, AND FLOOR

With your safety in mind, all C Series pools have hand-crafted, non-skid texture integrated into the surfaces of the ledge, steps, and pool floor.

* Non-Diving Pool
* See Safety Information

All measurements given reflect the dimensions of the pool to the exterior of the pool structure, and not the dimensions of the pool interior.
1. All depths reflect the depth of the pool structure. Water depths may vary depending on the amount of water in the pool.
2. Additional specifications are available at riverpoolsandspas.com.



I SERIES



The I Series features the perfect blend of curves and swim space with its tanning ledge, open pool interior and freeform shape.



POLO

River Pools®
CATCH THE WAVE

I SERIES

MARCO



LOOKING FOR THE PERFECT BLEND OF CURVES AND SWIM SPACE? THE I SERIES FEATURES A TANNING LEDGE, AN OPEN POOL INTERIOR, AND A STYLISH FREEFORM SHAPE.

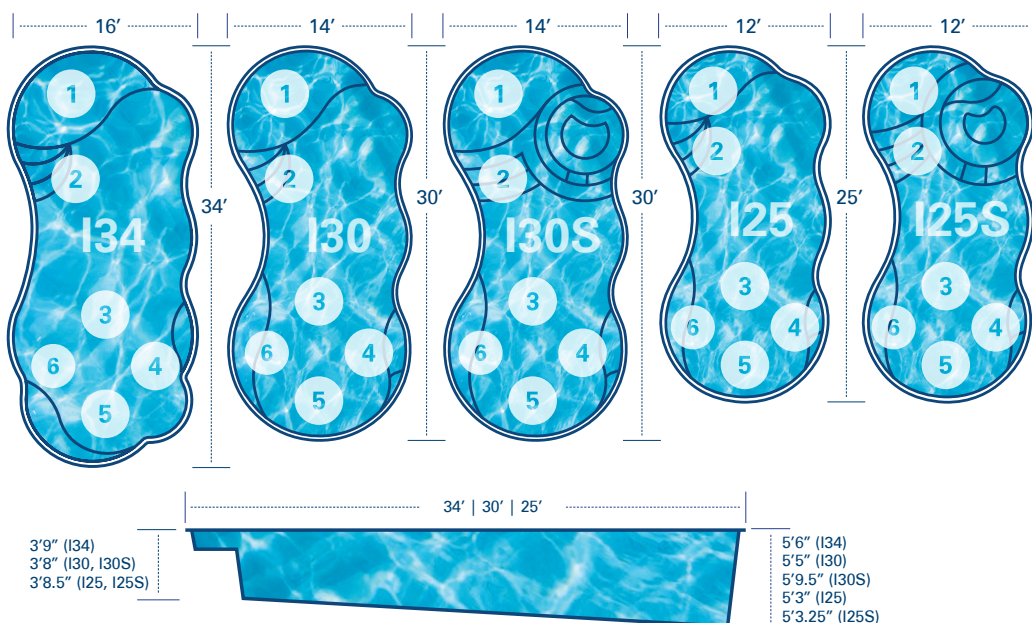

THE I SERIES FEATURES:

1 TANNING LEDGE

The I Series tanning shelf provides room to kick back and immerse yourself in a good book and catch some rays. Ask your installer about adding bubblers.

2 EASY-ENTRY POOL STEPS

The cascading steps of the I Series are specially designed so you can easily enter and exit the pool.

3 OPEN POOL INTERIOR

The I Series has all the style and space you could want. Who says you can't have your cake and eat it too?

4 DEEP-END SEAT

Relax in style with this contoured seating area and enjoy a great space for friends to relax together. Ask your installer about adding spa jets for the ultimate therapeutic experience.

5 TEXTURED POOL STEPS, TANNING LEDGE, AND FLOOR

With your safety in mind, hand-crafted, non-skid texture is integrated into the surfaces of the ledge, steps, and pool floor.

6 MULTIPLE ENTRY POINTS

The I Series offers an additional deep-end entry point to provide you easy entry and exit.

* Non-Diving Pool
* See Safety Information

All measurements given reflect the dimensions of the pool to the exterior of the pool structure, and not the dimensions of the pool interior.
1. All depths reflect the depth of the pool structure. Water depths may vary depending on the amount of water in the pool.
2. Additional specifications are available at riverpoolsandspas.com.



D SERIES



The D Series allows adults to lounge and relax, kids to splash and play, and both to discover a new dimension of the backyard pool experience.





River Pools®
CATCH THE WAVE

D SERIES

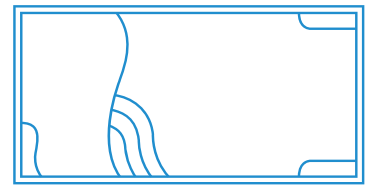

LOOKING FOR THE PERFECT TANNING LEDGE POOL? ADULTS CAN LOUNGE AND RELAX, KIDS CAN SPLASH AND PLAY, AND BOTH CAN DISCOVER A NEW DIMENSION OF THE BACKYARD POOL EXPERIENCE WITH THE D SERIES.

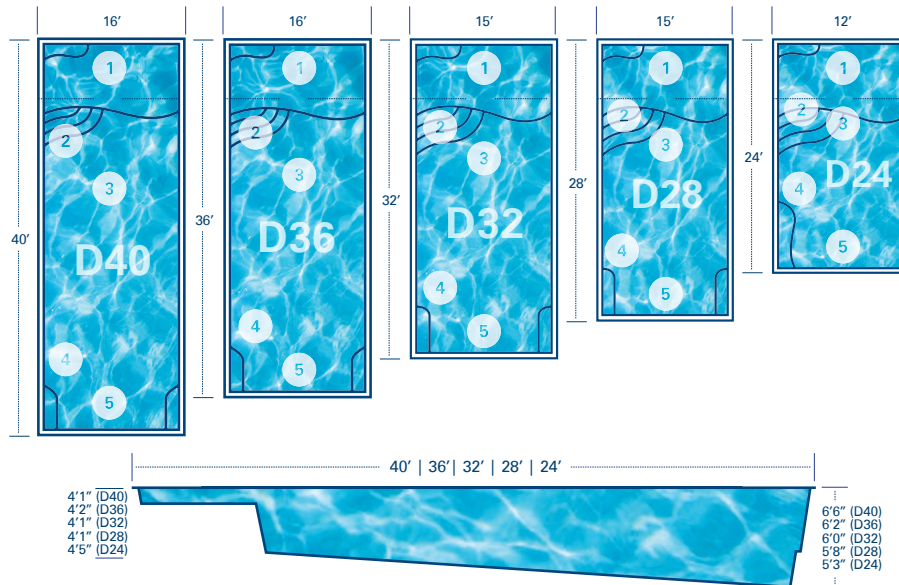

THE D SERIES FEATURES:

MARCO

- 1 SPACIOUS TANNING LEDGE**
 Designed to accommodate multiple lounge chairs, there's plenty of room to kick back and immerse yourself in a good book or catch some rays.
- 2 TEXTURED POOL STEPS, TANNING LEDGE, & FLOOR**
 With your safety in mind, the D Series has hand-crafted, non-skid texture integrated into the surfaces of the ledge, steps, and pool floor.
- 3 OPEN POOL INTERIOR**
 Looking for space? The rectangular design provides ample room to play or float to your heart's content. Fun and games encouraged!
- 4 DEEP-END BENCH SEATS**
 Relax in style with this contoured seating area and enjoy a great space for friends to relax together. Ask your installer about adding spa jets for the ultimate therapeutic experience.
- 5 AUTOMATIC COVER FRIENDLY**
 The rectangular design of the D Series allows cover tracks to be hidden beneath the pool coping, protecting them and keeping them out of sight.

* Non-Diving Pool
 * See Safety Information

All measurements given reflect the dimensions of the pool to the exterior of the pool structure, and not the dimensions of the pool interior.
 1. All depths reflect the depth of the pool structure. Water depths may vary depending on the amount of water in the pool.
 2. Additional specifications are available at riverpoolsandspas.com.

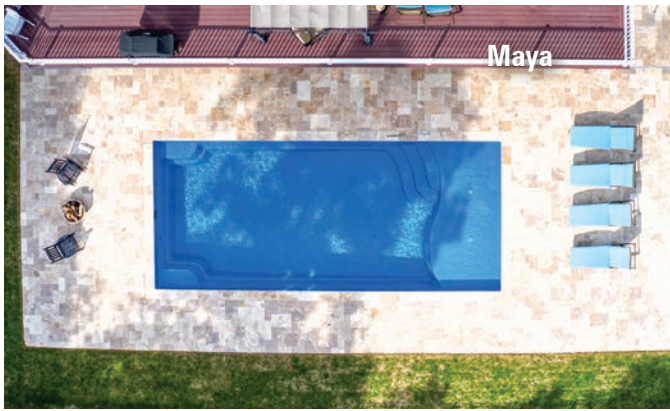

Maya



Diamond



Diamond



Arctic

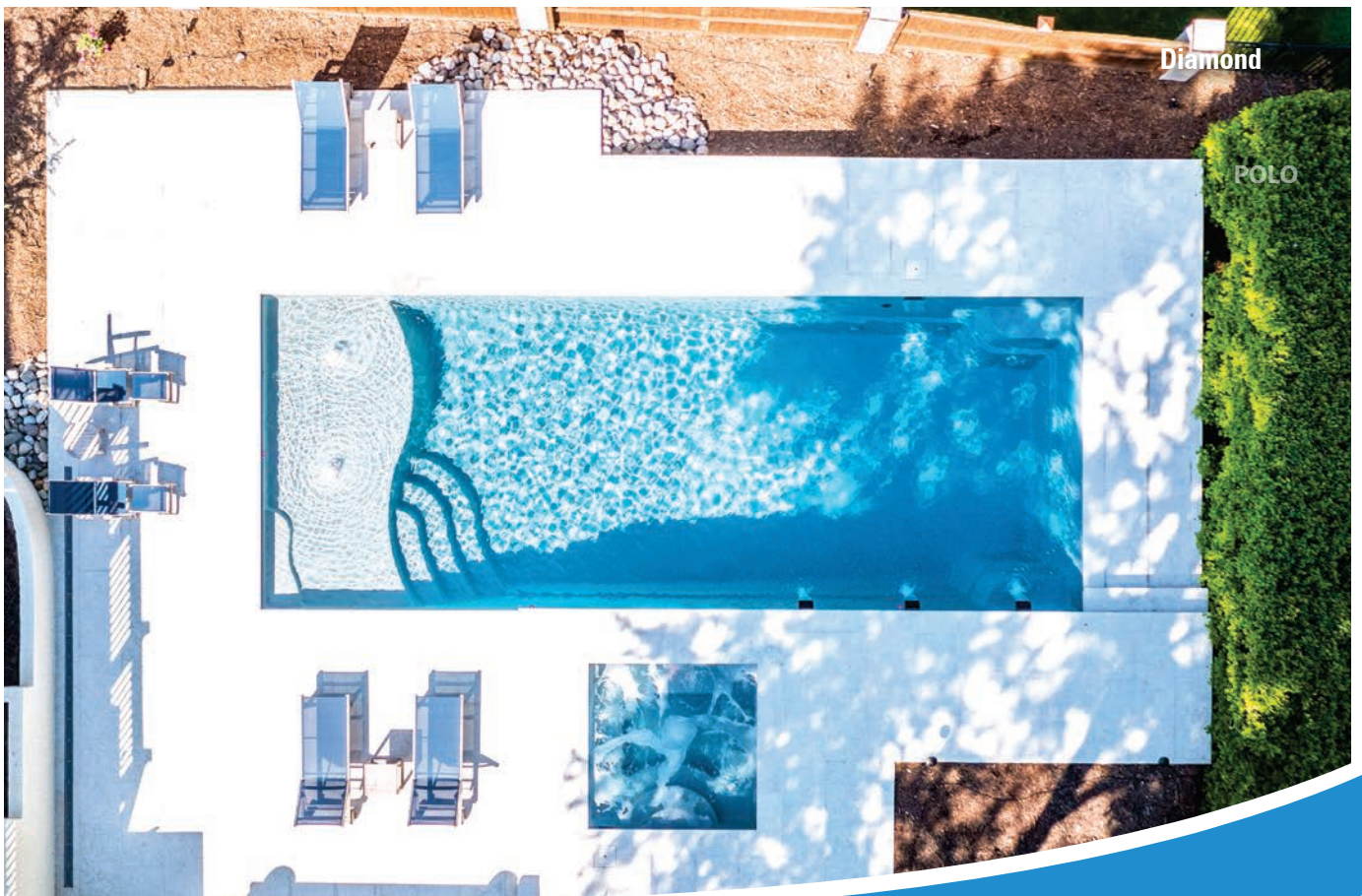

Diamond

POLO









R SERIES



The R Series embodies the harmony
of both functionality and style.

MARCO



POLO

POLO

River Pools®
CATCH THE WAVE

R SERIES



LOOKING FOR A SPACIOUS POOL WITH CLEAN LINES? THE R SERIES EMBODIES THE HARMONY OF BOTH FUNCTIONALITY AND STYLE.

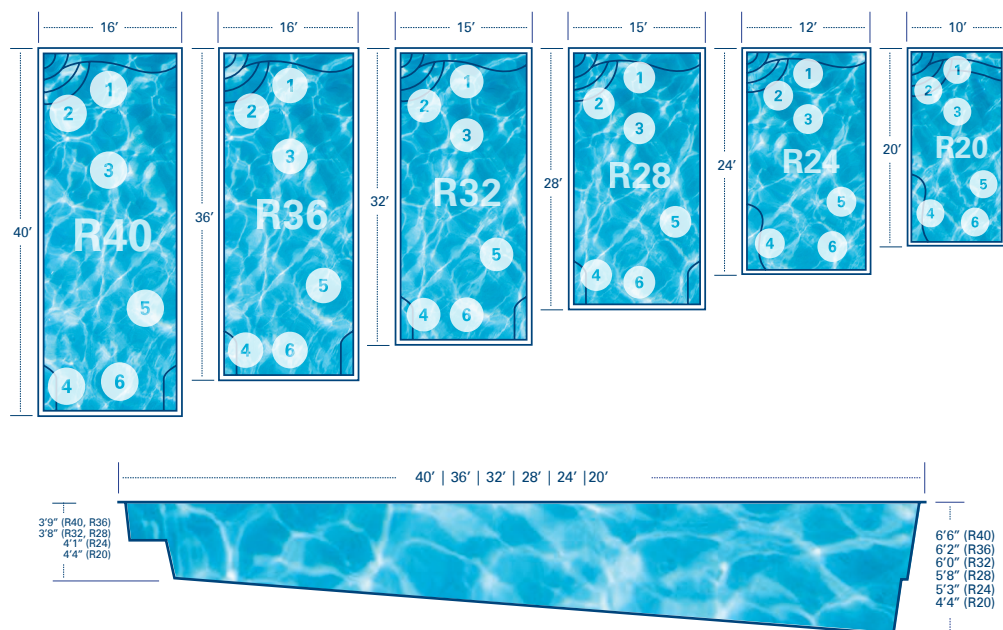

THE R SERIES FEATURES:

1 SHALLOW-END BENCH SEAT

Relax in style with this generous seating area and enjoy a great space for the entire family. Ask your installer about adding spa jets for the ultimate therapeutic experience.

2 CASCADING POOL STAIRS

The wedding cake-style steps of the R Series are specially designed for easy entry and exiting of the pool.

3 OPEN POOL INTERIOR

Want plenty of room to float and play games? The rectangular design of the R Series provides ample room for all of your pool activities.

4 DEEP-END BENCH SEATS

Want to take a break from the action and hang out with some friends? These seating areas, while tucked away in corners, are properly sized to accommodate multiple people.

5 TEXTURED POOL STEPS, TANNING LEDGE, AND FLOOR

With your safety in mind, all R Series pools have hand-crafted, non-skid texture integrated into the surfaces of the ledge, steps, and pool floor.

6 AUTOMATIC COVER FRIENDLY

The rectangular design of the R Series allows cover tracks to be hidden beneath the pool coping, protecting them and keeping them out of sight.

* Non-Diving Pool
* See Safety Information

All measurements given reflect the dimensions of the pool to the exterior of the pool structure, and not the dimensions of the pool interior.
1. All depths reflect the depth of the pool structure. Water depths may vary depending on the amount of water in the pool.
2. Additional specifications are available at riverpoolsandspas.com.



Maya



Caribbean



POLO

Maya



Diamond



Diamond

L36



The L36 is the perfect fit for those who want to enjoy a spacious tanning ledge, open pool interior, and generous seating area.







LOOKING FOR A TIMELESS DESIGN BLENDED WITH FUN FEATURES? THE L36 IS THE PERFECT FIT FOR THOSE WHO WANT THE ENJOYMENT OF A SPACIOUS TANNING LEDGE, OPEN POOL INTERIOR, AND GENEROUS SEATING AREA.

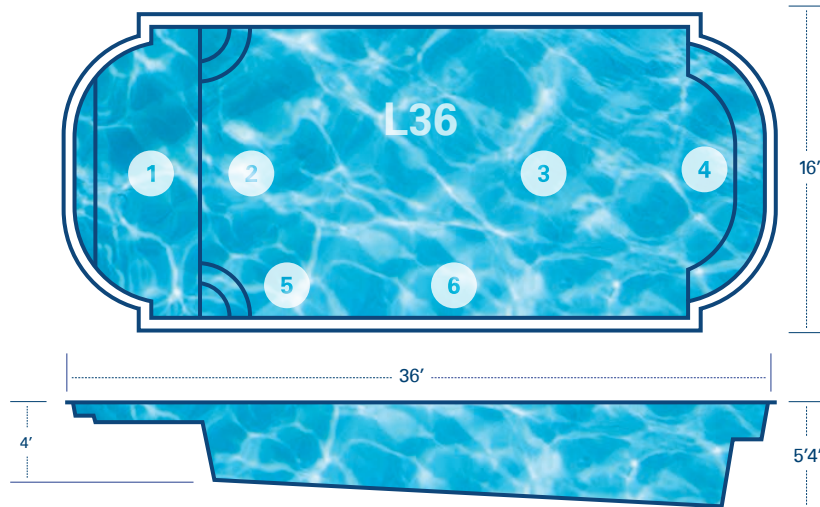

THE L36 FEATURES:

- 1 SPACIOUS TANNING LEDGE**
 Designed to accommodate multiple lounge chairs, this tanning ledge is perfect for relaxation and play. Kids and adults alike cannot get enough!
- 2 OPEN SWIM LANE**
 Equipped with wide open swim space, the L36 is perfect for lap swimming for the “fish” in your family.
- 3 OPEN POOL INTERIOR**
 Looking to play pool games or just float around? The L36 has plenty of room to accommodate all your needs.
- 4 GENEROUS BENCH SEAT**
 The perfect spot to relax with friends, this deep end bench seat could accommodate the entire family! Ask your installer about adding spa jets.
- 5 TEXTURED POOL STEPS, TANNING LEDGE, AND FLOOR**
 With your safety in mind, every L36 has hand-crafted, non-skid texture integrated into the surfaces of the ledge, steps, and pool floor.
- 6 AUTOMATIC COVER FRIENDLY**
 It is possible to install an undertrack automatic cover system on the L36.

* Non-Diving Pool
 * See Safety Information

All measurements given reflect the dimensions of the pool to the exterior of the pool structure, and not the dimensions of the pool interior.
 1. All depths reflect the depth of the pool structure. Water depths may vary depending on the amount of water in the pool.
 2. Additional specifications are available at riverpoolsandspas.com.



Arctic



Diamond



Maya



California



Maya

T40



The T40's open interior provides ample room for all your pool activities, while its deep-end area is deeper than standard deep-end pools.



MARCO



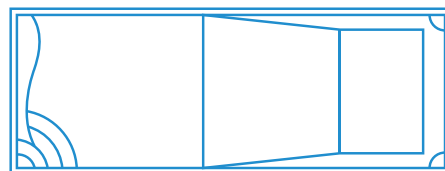

IF YOU'RE LOOKING FOR THE PERFECT DEEP-END FIBERGLASS POOL, LOOK NO FURTHER! SWIMMERS AND SOCIALIZERS CAN BOTH ENJOY THE T40 AT THE SAME TIME.

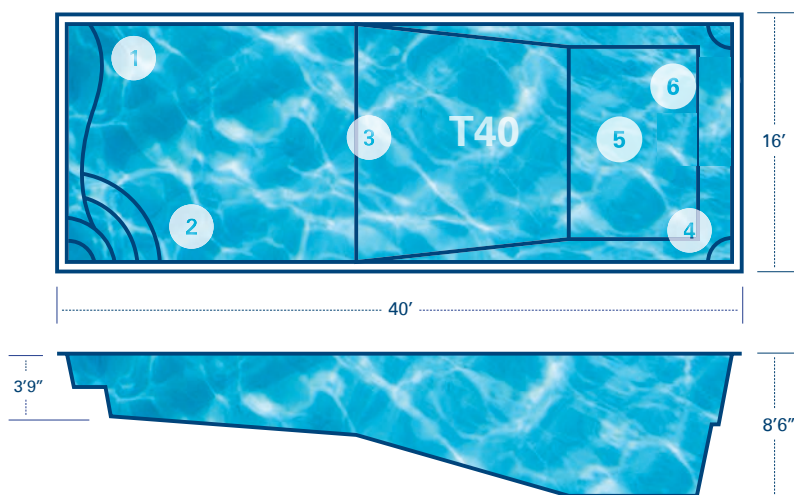

THE T40 FEATURES:

1 SPACIOUS SHALLOW-END BENCH SEAT

Want to take a break from the action and hang out with some friends? This seating area is properly sized to accommodate the whole family.

2 LARGE SHALLOW END FOR SOCIALIZING AND PLAY

The problem with most deep-end pools is a small shallow end, which is where most people gather. The T40 shallow end is a spacious 15 feet to accommodate larger groups.

3 OPEN POOL INTERIOR

Want plenty of room to float and frolic? The rectangular design of the T40 provides ample room for all of your pool activities.

4 DEEP-END SEATS / EXIT POINTS

When using deep-end pools, people love to be in the deep end, exit, and repeat. The deep-end seats of the T40 provide a place to get in and out, as well as take a rest.

5 MASSIVE 8'6" DEEP END

Looking for lots of water? You'll enjoy the large deep-end area. At 8'6", the T40 is deeper than standard deep-end pools.

6 AUTOMATIC COVER FRIENDLY

The rectangular design of the T40 allows cover tracks to be hidden beneath the pool coping, protecting them and keeping them out of sight.

* Type 1 Diving Pool
* See Safety Information

All measurements given reflect the dimensions of the pool to the exterior of the pool structure, and not the dimensions of the pool interior.

1. All depths reflect the depth of the pool structure. Water depths may vary depending on the amount of water in the pool.
2. Additional specifications are available at riverpoolsandspas.com.
3. River Pools® strongly recommends that diving boards and slides not be installed or used with its pools, given the inherent dangers associated with diving boards and slides in residential pools. These dangers include brain, spinal cord and other severe permanent injuries, and death. For that reason, River Pools® does not manufacture or sell diving boards or slides. If, despite this warning and recommendation, the owner decides to install or use a diving board or slide, the owner assumes all risks inherent with a diving board or slide, and River Pools® further warns that diving boards and slides require minimum depths and distances and must be installed and used in strict compliance with the equipment manufacturer's specifications and ANSI/NSPI, ANSI/APSP, and ANSI/APSP/ICC standards, as well as in compliance with all applicable laws, rules and regulations. The owner is responsible for making sure the pool is appropriate for diving boards and slides and otherwise meets all standards and laws for diving pools, and the owner must consult the diving board or slide manufacturer and/or installer as to the appropriateness of the pool for the diving board or slide and that its installation, location and use meet all standards and laws for diving and slide pools.



Maya



Diamond



Diamond

M SERIES



The M Series can host the perfect evening party after the workout is complete. The swim lane, tanning ledge and spacious benches of the M Series make the perfect plunge and play pool for one or many.





M SERIES

MARCO

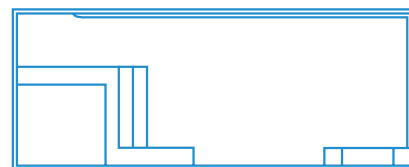

LOOKING FOR A MODERN DESIGN THAT CAN HOST THE PERFECT EVENING PARTY AFTER SWIMMING LAPS? THE SWIM LANE, TANNING LEDGE AND SPACIOUS BENCHES OF THE M SERIES MAKE THE PERFECT PLUNGE AND PLAY POOL FOR ONE OR MANY.

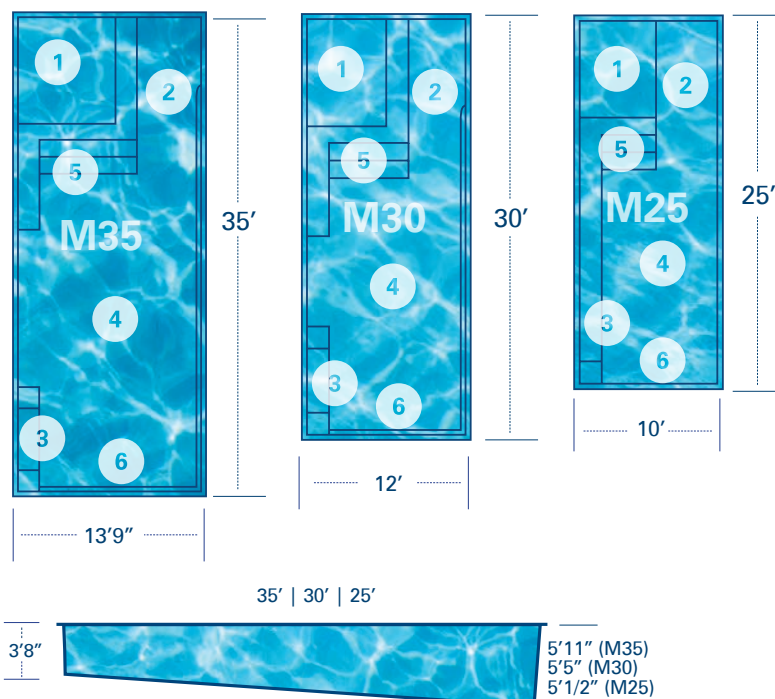

THE M SERIES FEATURES:

1 TANNING LEDGE

Designed to accommodate a lounge chair, there's plenty of room to kick back and immerse yourself in a good book or catch some rays.

2 OPEN POOL INTERIOR AND SWIM LANE

Looking for space to host a party, play or swim laps? The open interior and dedicated swim lane offers options throughout a hot summer day and into the evening.

3 SPACIOUS BENCH SEATING

Want to take a break from the action and hang out with some friends? The bench seating can get your whole crowd engaged with each other.

4 AUTOMATIC COVER FRIENDLY

The rectangular design of the M Series allows cover tracks to be hidden beneath the pool coping, protecting them and keeping them out of sight.

5 TEXTURED POOL STEPS, LEDGE, AND FLOOR

With your safety in mind, the M Series has hand-crafted, non-skid texture integrated into the surfaces of the ledge, steps, and pool floor.

6 MULTIPLE ENTRY POINT OPTIONS

The M Series offers options for handrail placement from the end or side of the tanning ledge. It also features multiple entry points while playing and relaxing from the deep end or shallow end.

* Non-Diving Pool
* See Safety Information

All measurements given reflect the dimensions of the pool to the exterior of the pool structure, and not the dimensions of the pool interior.
1. All depths reflect the depth of the pool structure. Water depths may vary depending on the amount of water in the pool.
2. Additional specifications are available at riverpoolsandspas.com.



X SERIES



Pool meets integrated spa meets tanning ledge in the X Series. The X36 has everything you need to relax, unwind, or throw that party that everyone will remember.



MARCO



X SERIES

MARCO

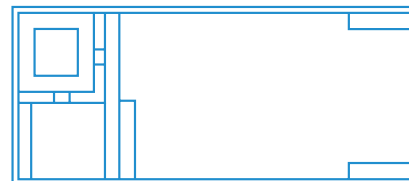

THIS ONE CHECKS ALL THE BOXES! RECTANGULAR POOL DESIGN MEETS INTEGRATED SPA MEETS TANNING LEDGE. THE X36 HAS EVERYTHING YOU NEED TO RELAX, UNWIND, OR THROW THAT PARTY THAT EVERYONE WILL REMEMBER. DID WE MENTION IT'S AUTO-COVER READY?

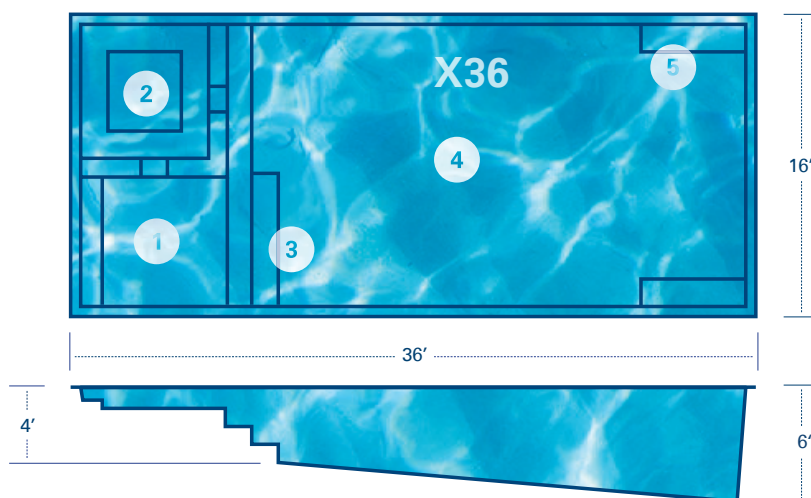

THE X SERIES FEATURES:

- 1 TANNING LEDGE**
Designed for relaxation, lie back in a submerged lounger or entertain the younger crowd in shallow waters.
- 2 INTEGRATED SPA WITH SPILLWAY**
The integrated spa provides a faster installation process with a seamless aesthetic.
- 3 EASY ENTRY STEPS**
Textured with a non-skid finish, the pool steps allow for easy entry and exit.
- 4 AUTO-COVER READY**
The rectangular design allows cover tracks to be hidden beneath the pool coping, protecting them and keeping them out of sight.
- 5 SPACIOUS INTERIOR & BENCH SEATING**
With plenty of room for an epic game of Marco Polo, relaxing conversation, or both, the X Series provides something for everyone.

* Non-Diving Pool
* See Safety Information

All measurements given reflect the dimensions of the pool to the exterior of the pool structure, and not the dimensions of the pool interior.
1. All depths reflect the depth of the pool structure. Water depths may vary depending on the amount of water in the pool.
2. Additional specifications are available at riverpoolsandspas.com.

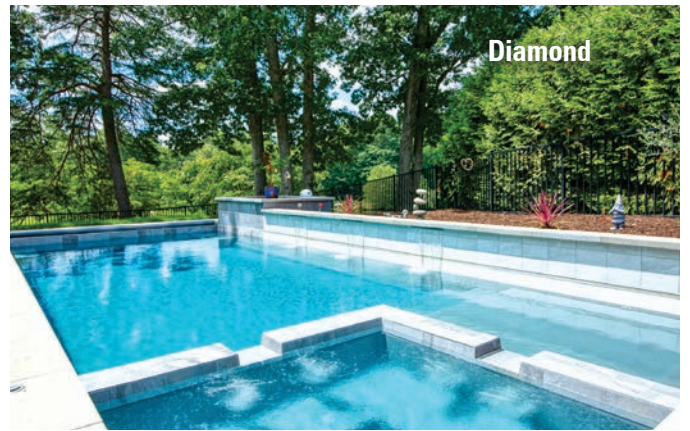

POOL ADD-ONS

SPAS

ADD A SQUARE OR ROUND SPA FOR NEXT LEVEL RELAXATION! THE ROUND SPA COMES WITH A SPILLWAY, AND THE SQUARE SPA OFFERS THE SPILLWAY AS AN OPTION.

SPA FEATURES:

- 1 CASCADING ENTRY STEPS WITH TEXTURED SURFACE
- 2 NON-SKID SURFACE ON FLOOR
- 3 SPILLWAY COMES STANDARD ON RS08 AND IS OPTIONAL ON SS08
- 4 GREAT FOR RAISED DECK APPLICATIONS

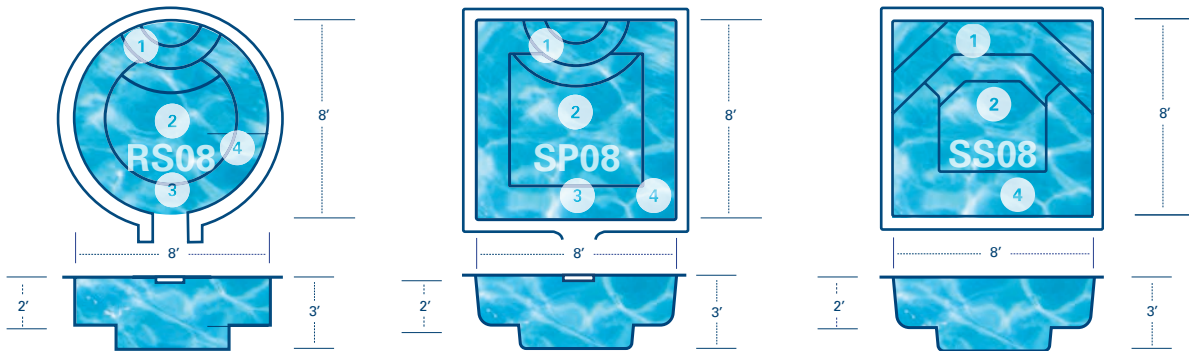

POOL ADD-ONS

TANNING LEDGES

ADD A TANNING LEDGE TO YOUR FIBERGLASS POOL FOR THE NEXT LEVEL OF LUXURY!

TANNING LEDGES FEATURES:

- ① 8" DEEP SHALLOW LOUNGING AREA (TL09)
- ② 1' DEEP SHALLOW LOUNGING AREA (TL15)
- ③ NON-SKID SURFACE ON FLOOR
- ④ SPILLWAY STANDARD
- ⑤ GREAT FOR RAISED DECK APPLICATIONS

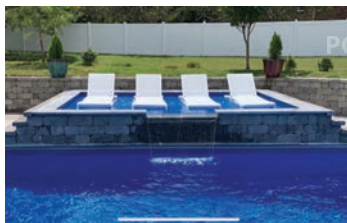
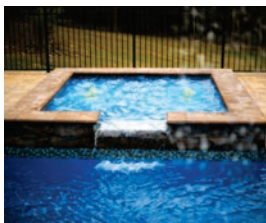
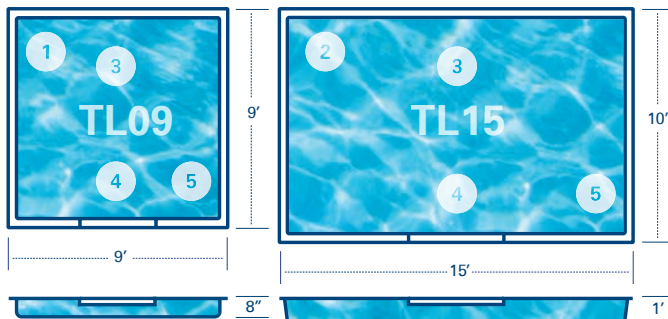

* Non-Diving Pool
* See Safety Information

All measurements given reflect the dimensions of the pool to the exterior of the pool structure, and not the dimensions of the pool interior.

1. All depths reflect the depth of the pool structure. Water depths may vary depending on the amount of water in the pool.
2. Additional specifications are available at riverpoolsandspas.com.



MARCO

COLOR OPTIONS

RIVER POOLS OFFERS THE FOLLOWING COLORS
FOR THE GELCOATS OF OUR FIBERGLASS POOLS



CARIBBEAN (Standard)

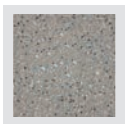

DIAMOND (Standard)



ARCTIC (Standard)



MAYA



CALIFORNIA

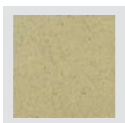

SANDSTONE

REFER TO RIVERPOOLSANDSPAS.COM FOR EXAMPLES OF THESE COLORS WITH WATER

Note: All colors can suffer damage if water chemistry is not within range at all times.
The final finished product may vary from the color samples on this page.







COMMITMENT TO BRINGING FAMILIES TOGETHER

From our humble origins to building high-quality fiberglass pools in a state-of-the-art facility, the River Pools mission has always been to bring families together. Whether your family is small, large, or somewhere in between, a modern fiberglass pool is the perfect backdrop for your gatherings.

COMMITMENT TO EMPLOYEE SAFETY

We hope you can sense the passion we have for building fiberglass pools that benefit you and your family. Our facility puts practices and standards in place to ensure your pool is being built with high-quality materials and is designed following tried and true quality management criteria. Along with prioritizing quality control, we focus on employee health and safety. Each production room contains laminar airflow, meaning air passes through the space evenly and allows for only fresh air to circulate through the room.

COMMITMENT TO THE ENVIRONMENT

Our passion also extends outside facility walls to protecting the environment as much as possible. We strive to minimize our environmental footprint and implement strategies to continuously improve. A regenerative thermal oxidizer device destroys up to 98% of volatile organic compounds (VOCs) produced during the pool-building process and turns them into CO₂ and H₂O. This keeps the air clean and aids in protecting both the local community and the greater world around us. River Pools is a proud member of the Indiana Partners for Pollution Prevention and the Indiana Department of Environmental Management's Environmental Stewardship Program and is recognized for going above and beyond existing environmental regulations. In reducing our environmental footprint, we hope you will feel encouraged that you are choosing the right pool manufacturer.

COMMITMENT TO CONTINUOUS IMPROVEMENT

You can feel confident that your pool is produced with both durability and the environment in mind. Our pools are produced in a manufacturing facility that utilizes Quality Control (QC) methods and actively searches for ways to improve them. We hold certifications that showcase our QC and environmental commitments, known as ISO 9001 and ISO 14001, respectively. These certifications require organizations to follow tried-and-true quality control practices as well as an effective Environmental Management System. Continuous review and improvement are also a requirement for each, so you'll know your pool comes from a place striving for constant improvement throughout its processes.





GREAT CARE BEGINS WITH WATER CHEMISTRY

You must maintain proper water chemistry to ensure the best protection of your fiberglass pool's surface finish. Proper water chemistry involves both water balance and ideal levels of chemicals in the water. Water balance refers to the Saturation Index (Si). The saturation index is commonly calculated using the Langelier Saturation Index method. This calculation relates to pH, alkalinity, conductivity/TDS, hardness (calcium), cyanuric acid, and temperature. pH significantly affects the calculation, but note that chlorine has none. The ideal Si is -0-. A positive Si will be more likely to stain and scale, and a negative Si will be more corrosive. Balanced pool water means the Si is -0-. The minimum water chemical levels that should be maintained are pH, alkalinity, free chlorine, cyanuric acid, hardness, metals TDS, and salt if necessary.

Note: the pool owner is ultimately responsible for the water chemistry that will determine whether the fiberglass surface has received proper care. A pool owner must have complete knowledge of pool water chemistry and maintenance to care for the pool themselves. If they do not have that knowledge, they are responsible for locating and using someone that does. They must still ensure that any outside help they employ is competent in pool water chemistry and maintenance specific to a fiberglass pool.

KEEP IT SAFE WITH AN AUTOMATIC POOL COVER

Automatic pool covers help protect your pool investment, and even more importantly, they help protect those who matter most. Safety will always be your top concern with your new pool, and an automatic pool cover will give you added security and peace of mind.

An automatic pool cover will provide you with a more enjoyable pool ownership experience by reducing the amount of time, money, and energy you'll need to spend on pool maintenance. They keep debris out and chemicals in.

It's important to note that automatic pool covers should never be the sole barrier to pool entry. River Pools, along with The Pool and Hot Tub Alliance, believe every pool should have multiple layers of protection, such as fencing with locking gates, alarms, etc.

WHAT TO EXPECT FROM RIVER POOLS

Once you decide on the pool of your dreams, a process is in place to keep things moving smoothly. Here is an overview of that process, as well as some important things you should know:

You will be asked to sign an acknowledgment and register your warranty before signing your contract with your Installer. However, your warranty does not take effect until installation.

Pool shell orders require a 50% deposit from the Installer to River Pools to go into production. This means the production lead time we have established will not begin until the deposit is received.

Ask your Installer for a lead time at the time of your pool shell order. Only your Installer can answer questions concerning payment, production, or delivery of your pool shell.

Prior to shipping being scheduled, your Installer must pay any remaining balance. Again, all requests and questions concerning pool shell orders and delivery must be directed to the Installer.

Do your due diligence. Installers go through an application process; however, that should not replace your own vetting of the Installer. River Pools is not responsible for the obligations of the Installer. Ask for references. Ensure the Installer can answer all your questions thoroughly, professionally, and patiently. Be leary of down payments that are significantly above the market average. An ideal draw schedule should match the amount of work done.

Read through your contract with your Installer. Make sure you understand everything outlined within it, and ask any questions you have prior to signing. Consider getting a second opinion if you are not certain. River Pools is not privy to your contract details, so any questions should be directed to your Installer.

*Installers, including dealers and franchisees, are not employed by or agents of River Pools. They own and operate their own companies. River Pools is simply a vendor to said company.



WARRANTY



Your new inground fiberglass pool is a once-in-a-lifetime investment that should be protected by a comprehensive warranty. At River Pools, we operate on three guiding principles: honesty, integrity, and mutual respect. Those principles guide our warranty too. When you buy a River Pools fiberglass pool, you'll find that our warranty is comprehensive and easy to understand.

Our Standard One-time Transferable Limited Warranty Includes:

Fiberglass Pool Limited Lifetime Structural Warranty: River Pools warrants your pool will not leak due to structural failures caused by workmanship and material used in the manufacturing of the pool.

15-Year Pool Surface Warranty: River Pools offers a 15-year surface warranty against osmotic blistering.

To learn more about the warranty, scan the code below or visit riverpoolsandspas.com.



VOTE ON IT.

POLO

THIS IS AMERICA! HAVE YOUR FRIENDS AND FAMILY VOTE WHICH POOL SERIES FITS YOU BEST AND GET MORE INFORMATION ON THE ONE(S) WITH THE MOST "YESES."

C SERIES

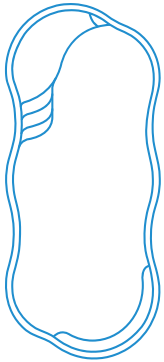

- #1 ☐ Yes ☐ No ☐ Maybe
- #2 ☐ Yes ☐ No ☐ Maybe
- #3 ☐ Yes ☐ No ☐ Maybe
- #4 ☐ Yes ☐ No ☐ Maybe
- #5 ☐ Yes ☐ No ☐ Maybe

I SERIES



- #1 ☐ Yes ☐ No ☐ Maybe
- #2 ☐ Yes ☐ No ☐ Maybe
- #3 ☐ Yes ☐ No ☐ Maybe
- #4 ☐ Yes ☐ No ☐ Maybe
- #5 ☐ Yes ☐ No ☐ Maybe

D SERIES

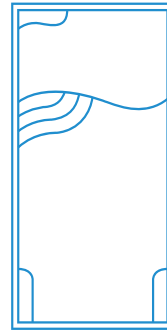

- #1 ☐ Yes ☐ No ☐ Maybe
- #2 ☐ Yes ☐ No ☐ Maybe
- #3 ☐ Yes ☐ No ☐ Maybe
- #4 ☐ Yes ☐ No ☐ Maybe
- #5 ☐ Yes ☐ No ☐ Maybe

R SERIES

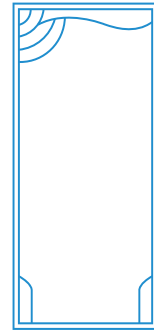

- #1 ☐ Yes ☐ No ☐ Maybe
- #2 ☐ Yes ☐ No ☐ Maybe
- #3 ☐ Yes ☐ No ☐ Maybe
- #4 ☐ Yes ☐ No ☐ Maybe
- #5 ☐ Yes ☐ No ☐ Maybe

L SERIES

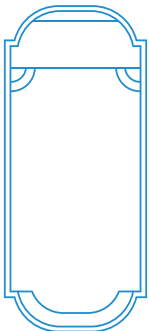

- #1 ☐ Yes ☐ No ☐ Maybe
- #2 ☐ Yes ☐ No ☐ Maybe
- #3 ☐ Yes ☐ No ☐ Maybe
- #4 ☐ Yes ☐ No ☐ Maybe
- #5 ☐ Yes ☐ No ☐ Maybe

T SERIES

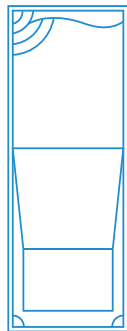

- #1 ☐ Yes ☐ No ☐ Maybe
- #2 ☐ Yes ☐ No ☐ Maybe
- #3 ☐ Yes ☐ No ☐ Maybe
- #4 ☐ Yes ☐ No ☐ Maybe
- #5 ☐ Yes ☐ No ☐ Maybe

M SERIES

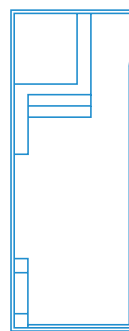

- #1 ☐ Yes ☐ No ☐ Maybe
- #2 ☐ Yes ☐ No ☐ Maybe
- #3 ☐ Yes ☐ No ☐ Maybe
- #4 ☐ Yes ☐ No ☐ Maybe
- #5 ☐ Yes ☐ No ☐ Maybe

X SERIES

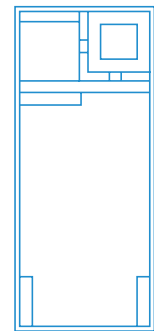

- #1 ☐ Yes ☐ No ☐ Maybe
- #2 ☐ Yes ☐ No ☐ Maybe
- #3 ☐ Yes ☐ No ☐ Maybe
- #4 ☐ Yes ☐ No ☐ Maybe
- #5 ☐ Yes ☐ No ☐ Maybe

CHATELAIN DESIGN USA LTD CO LLC

803-324-6802

237 PARK AVE SW, SUITE 216

AIKEN, SC 29801

aikenriverpools.com



RIVER POOLS

840 COMMERCE PARKWAY,
FORTVILLE, INDIANA 46040

CONTACT

T: 877.929.1829

FOR QUESTIONS OR MORE INFORMATION, PLEASE VISIT RIVERPOOLSANDSPAS.COM



RIVERPOOLSANDSPAS.COM